

FOR SUBLEASE ±3,000 SF MEDICAL OFFICE
7790 W GRAND PARKWAY S / RICHMOND, TX 77406



FOR SUBLEASE ±3,000 SF
7790 W Grand Parkway S, Suite 100
Richmond, TX 77406

PROPERTY OVERVIEW

- 3,000 RSF
- Suite 100
- Term thru 10/31/2030
- Rate Negotiable
- Furniture Negotiable
- Available Immediately
- Parking: 3/1,000 RSF plus 3 Reserved Spaces

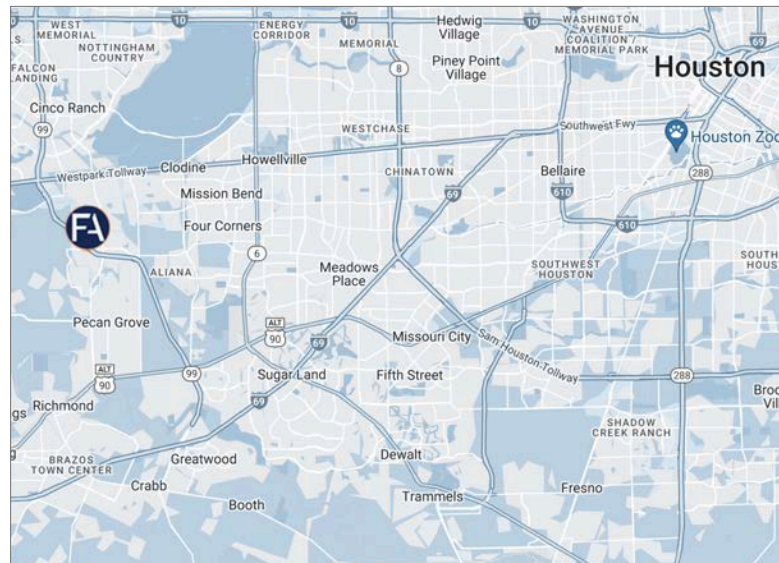

MIKE QUINN
D / 713.275.3807
M / 713.252.9623
mquinn@fritscheanderson.com

FOR SUBLEASE ±3,000 SF MEDICAL OFFICE 7790 W GRAND PARKWAY S / RICHMOND, TX 77406



MIKE QUINN

D / 713.275.3807

M / 713.252.9623

mquinn@fritscheanderson.com

FOR SUBLEASE ±3,000 SF MEDICAL OFFICE 7790 W GRAND PARKWAY S / RICHMOND, TX 77406



FLOOR PLAN

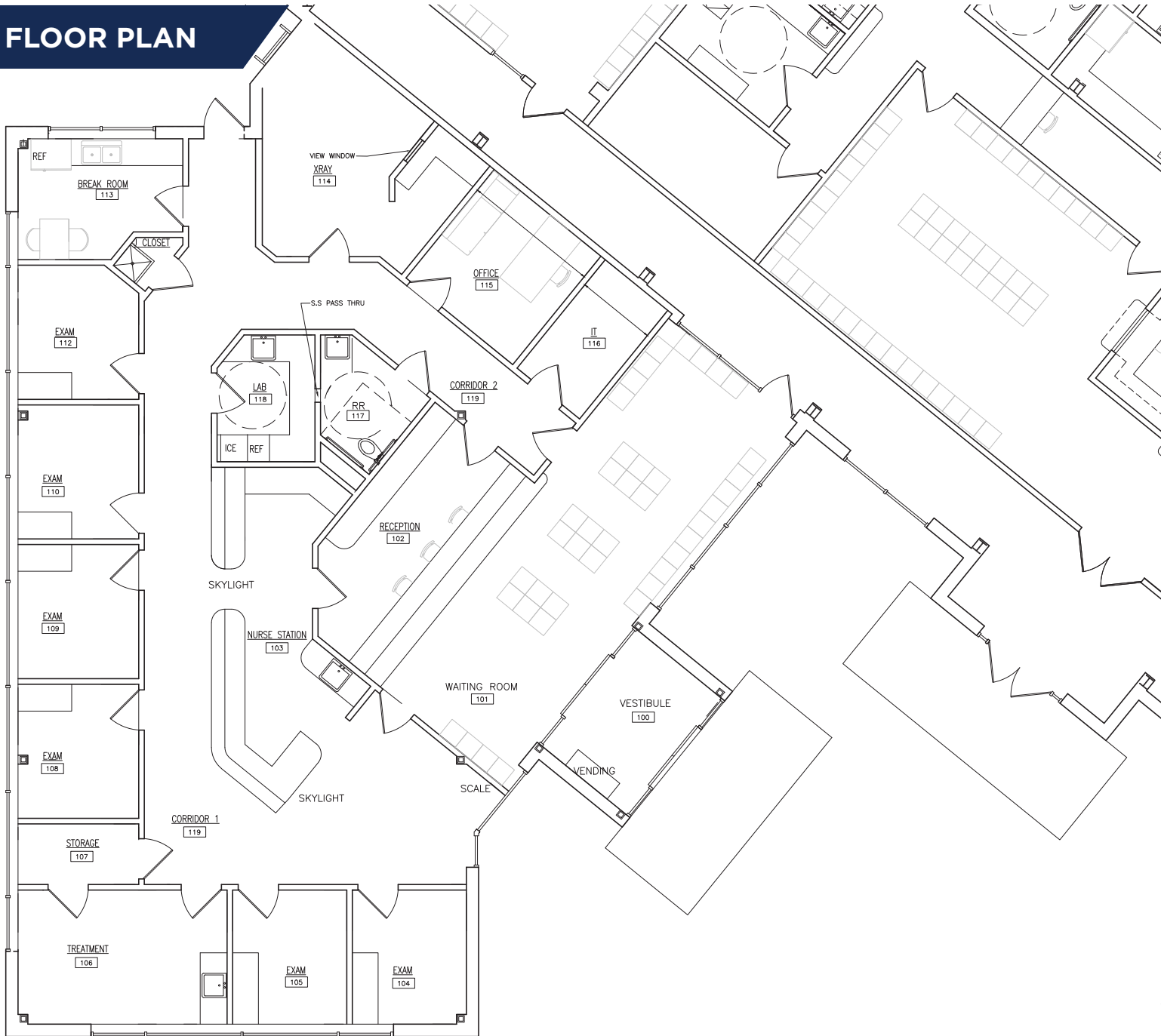

MIKE QUINN

D / 713.275.3807

M / 713.252.9623

mquinn@fritscheanderson.com

The information provided herein was obtained from sources believed reliable; however, Fritsche Anderson Realty Partners makes no guarantees, warranties or representations, express or implied, as to the completeness or accuracy thereof. The presentation of this property is submitted subject to errors, omissions, changes of price or conditions, prior sale or lease, or withdrawal without notice. Fritsche Anderson does not accept any liability for loss or damage suffered by any party reliant on this information.